

**Authorised Vehicles Only**  
 Mon - Sat  
 7 am - 9 am  
 3 pm - 6 pm  
 120 yds ahead

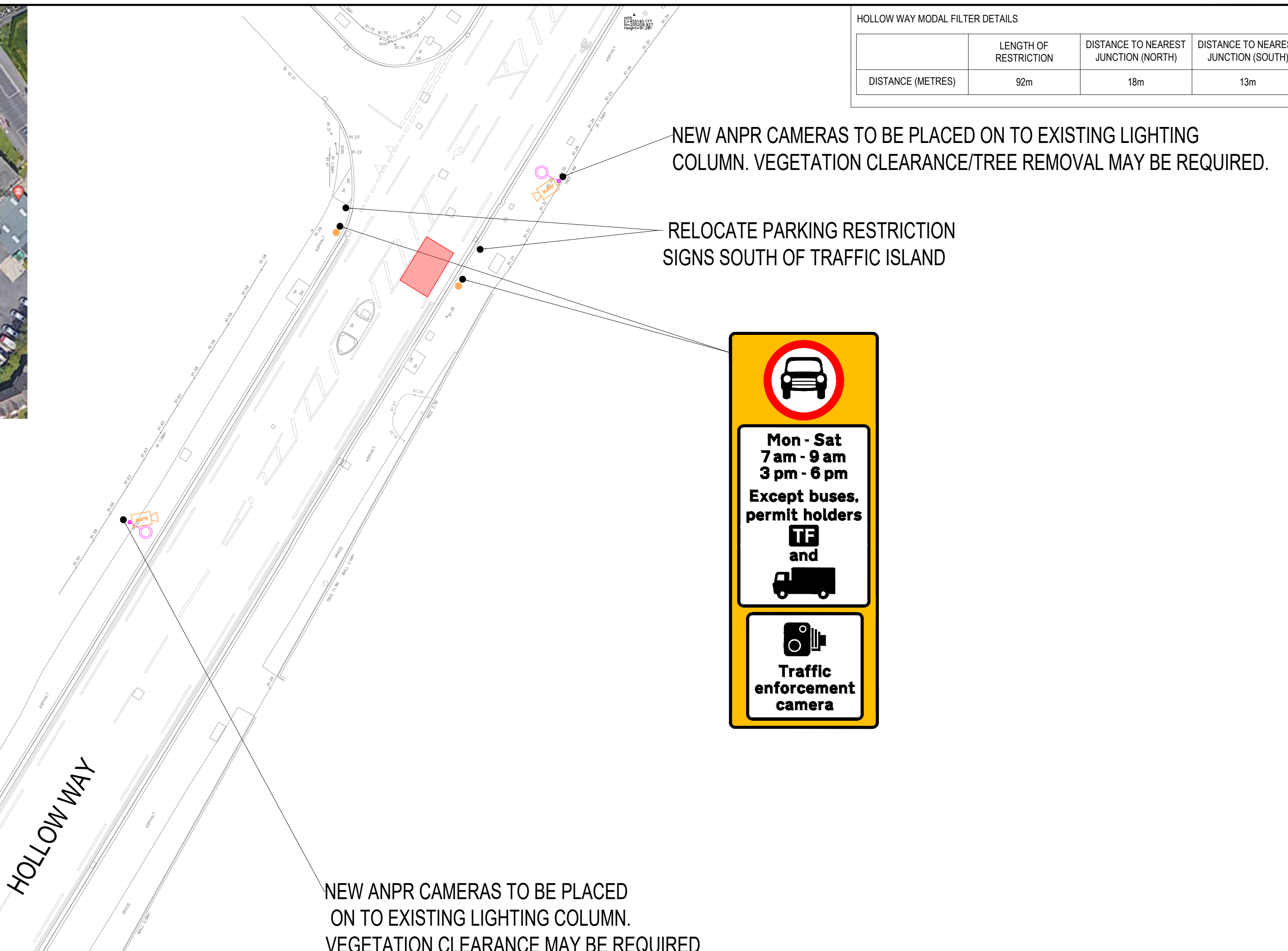

HOLLOW WAY MODAL FILTER DETAILS

	LENGTH OF RESTRICTION	DISTANCE TO NEAREST JUNCTION (NORTH)	DISTANCE TO NEAREST JUNCTION (SOUTH)
DISTANCE (METRES)	92m	18m	13m

**DO NOT SCALE**

NOTES:

- ALL DIMENSIONS ARE IN METRES UNLESS OTHERWISE STATED
- ANPR CAMERAS ASSUMED TO BE PLACED ON TO EXISTING LIGHTING COLUMN TO REDUCE ON-STREET CLUTTER. FURTHER INVESTIGATION ON STRUCTURAL SUITABILITY REQUIRED.
- SIGN POST AND FOUNDATIONS DETAILS TO BE SPECIFIED DURING DETAILED DESIGN.
- SIGN LOCATIONS ASSUME NO CLASHES WITH UNDERGROUND UTILITIES. FURTHER ANALYSIS REQUIRED AT DETAILED DESIGN STAGE.

- KEY:
- NEW ILLUMINATED SIGN POST
  - NEW SIGN POST
  - EXISTING ILLUMINATED SIGN POST TO BE REMOVED
  - EXISTING STREET LIGHTING COLUMN TO BE RETAINED
  - NEW ANPR CAMERA TO BE INSTALLED
  - CIRCLE DENOTES SIDE SIGN FACE IS MOUNTED
  - RED SURFACING TO HIGHLIGHT TRAFFIC FILTER

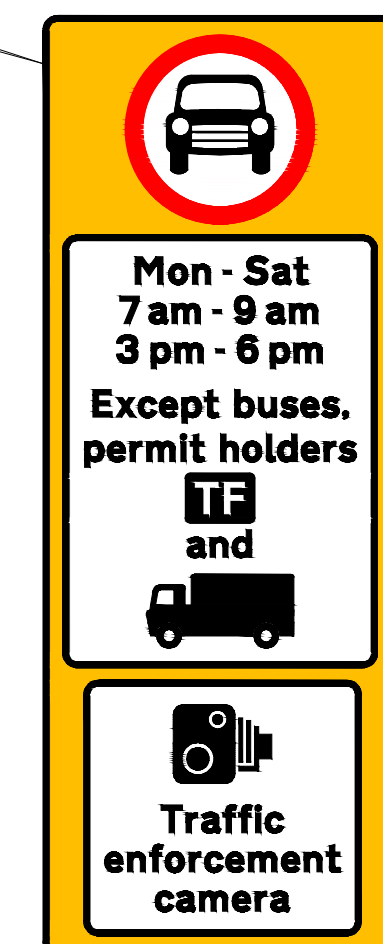

NEW ANPR CAMERAS TO BE PLACED ON TO EXISTING LIGHTING COLUMN. VEGETATION CLEARANCE MAY BE REQUIRED

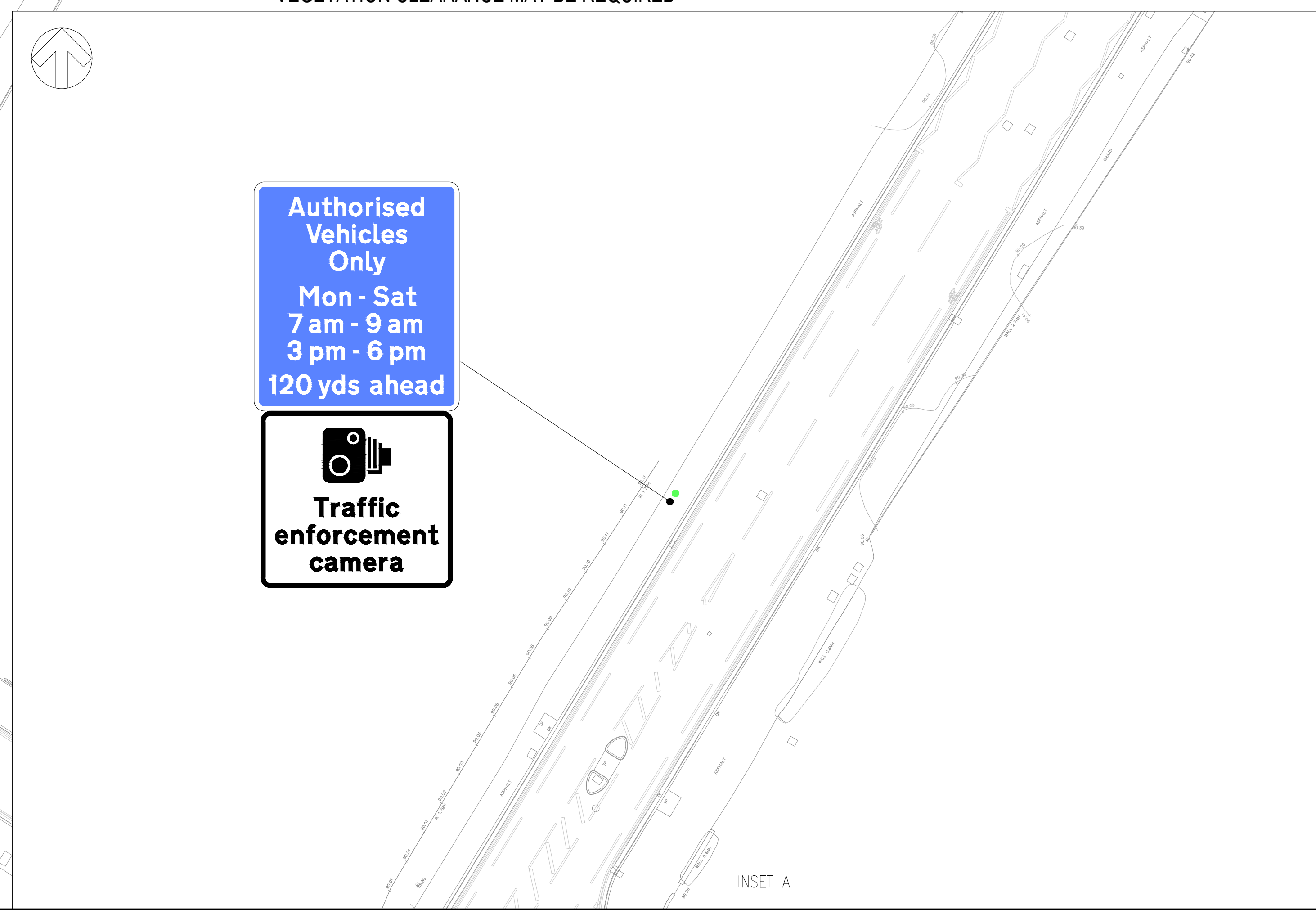
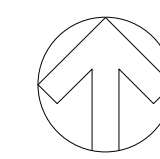

**Authorised Vehicles Only**  
 Mon - Sat  
 7 am - 9 am  
 3 pm - 6 pm  
 120 yds ahead

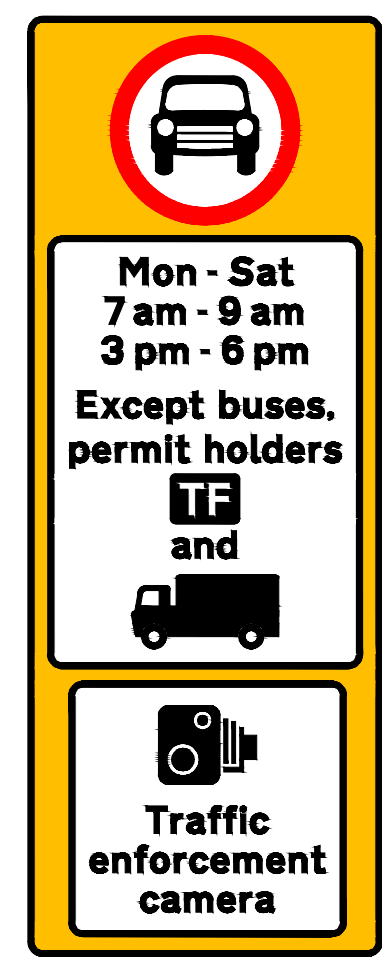

FOR CONTINUATION SEE INSET A

REV	DATE	BY	DESCRIPTION	CHK	APP
A	04/11/2022	HL	FIRST ISSUE		

DRAWING STATUS: **S2 - FOR INFORMATION**



CLIENT: **OXFORDSHIRE COUNTY COUNCIL**

ARCHITECT:

SITE/PROJECT: **OXFORD TRAFFIC FILTERS**

TITLE: **TRAFFIC FILTER - HOLLOW WAY VERSION 3**

SCALE @ A1:	CHECKED:	APPROVED:	
1:250	SB	SB	
PROJECT NO:	DESIGNED:	DRAWN:	DATE:
70092500	HL	HL	November 22

DRAWING No: **HOLLOW WAY V3** REV: **A**

© WSP UK Ltd

File name: \\UK-WSP-GROUP\COM\CENTRAL\DATA\PROJECTS\70092500\70092500 - CCC CONNECTING OXFORDS\03\WIP\TRAFFIC FILTERS\HOLLOW WAY V3.DWG, printed on 09 November 2022 10:31:52, by: Razaan, Jack