

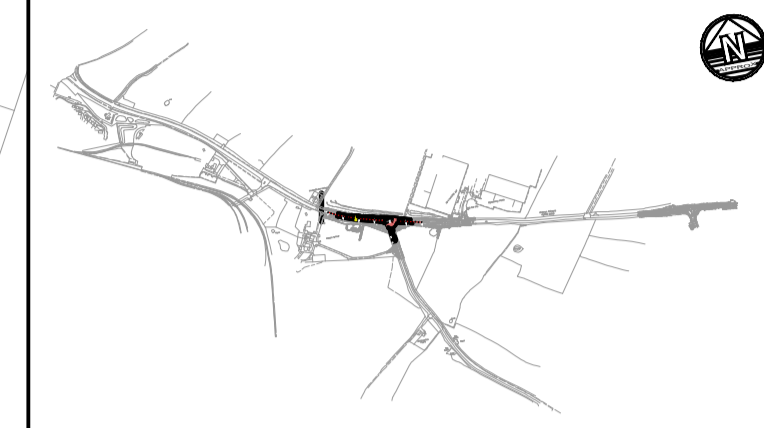

**NOTES**

- DO NOT SCALE THIS DRAWING. ALL DIMENSIONS MUST BE CHECKED/VERIFIED ON SITE. IF IN DOUBT ASK.
- ALL DIMENSIONS IN METRES UNLESS NOTED OTHERWISE. ALL LEVELS IN METRES UNLESS NOTED OTHERWISE.
- ANY DISCREPANCIES NOTED ON SITE ARE TO BE REPORTED TO THE ENGINEER IMMEDIATELY.
- DRAWING SHOULD BE PRINTED IN COLOUR.
- PLEASE NOTE THAT THIS DRAWING IS TO BE READ IN CONJUNCTION WITH ALL APPROVED DETAILED DESIGN DRAWINGS RELATED TO THE A41/PLOUGHLEY ROAD PROJECT.
- THIS DRAWING AND ALL OF THE ELEMENTS CONTAINED HEREIN ARE SUBJECT TO TA FROM OCC AND ARE THEREFORE SUBJECT TO CHANGE PRIOR TO CONSTRUCTION WORKS COMMENCING.

**KEY PLAN**



**LEGEND**

- Existing Lighting Column to be retained
- Proposed Lighting Column \*\*m high
- Proposed illuminated bollards in traffic islands
- Proposed non-illuminated bollards
- Proposed 6.00m high wide based traffic signal pole including secondary signal head and CCTV
- Proposed 4.00m high traffic signal pole (straight) including primary signal head
- Proposed 2.00m high traffic signal pole (straight)
- Proposed Bus Stop pole
- Proposed Landscaping/Hedgerow replacement
- Proposed Footway/Cycleway construction
- Proposed Carriageway construction
- Proposed Traffic Islands
- Proposed Earthworks at 1:2 slopes
- Proposed grass verged areas
- Proposed Tactile paving (Red)
- Proposed Tactile paving (Buff)
- Proposed Cycleway demarcation paving (Buff)
- Proposed cycle lane diverge ramps (Buff)
- Proposed High Friction Surfacing (HFS)
- Proposed 0.50m at grade segregation between shared use footway/cycleway and carriageway
- Proposed Grasscrete hardstanding

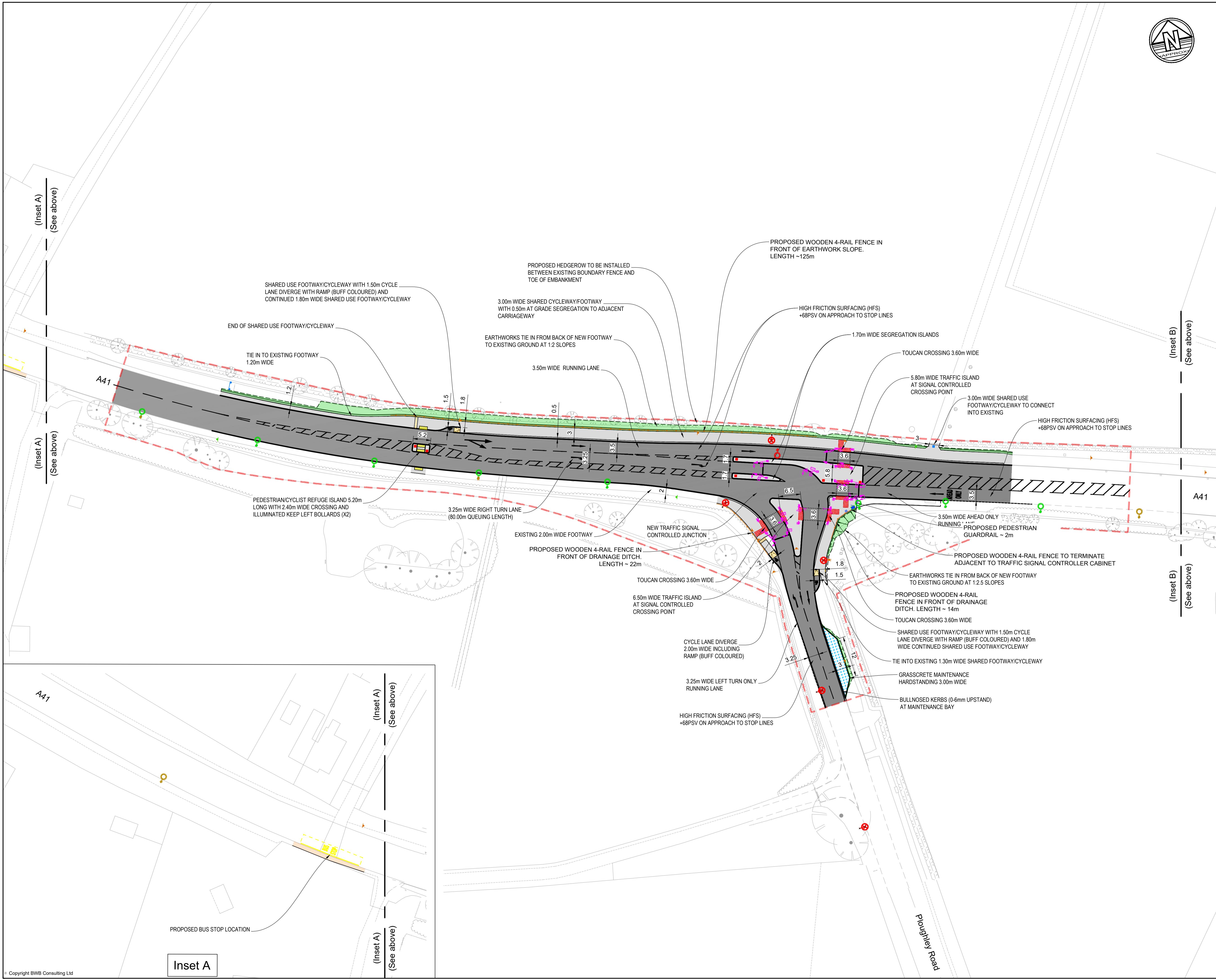

(Inset A)  
(See above)

(Inset A)  
(See above)

(Inset B)  
(See above)

(Inset B)  
(See above)

(Inset A)  
(See above)

(Inset A)  
(See above)

**Inset A**

P01	01.04.22	Issued for Approval	AK	LH
Rev	Date	Details of issue / revision	Dw	Rev

**Issues & Revisions**

**BWB**  
A CAF GROUP COMPANY

- Birmingham | 0121 233 3322
- Leeds | 0113 233 8000
- London | 020 7407 3879
- Manchester | 0161 233 4260
- Nottingham | 0115 924 1100

www.bwbconsulting.com

Client

**GallifordTry**

Project Title

**A41 PLOUGHLEY ROAD JUNCTION**

Drawing Title

**GENERAL ARRANGEMENT**

Drawn:	A. King	Reviewed:	L. Hames
BWB Ref:	NTH2514	Date:	01.04.22
Scale@A1:	1:500		
<b>ISSUED FOR APPROVAL</b>			
Project - Originator - Zone - Level - Type - Role - Number	Status	Rev	
<b>A41PR-BWB-HGN-XX-DR-C-0100</b>	<b>S4</b>	<b>P01</b>	