

IT IS ASSUMED THAT ALL WORKS ON THIS DRAWING WILL BE CARRIED OUT BY A COMPETENT CONTRACTOR WORKING, WHERE APPROPRIATE, TO AN APPROPRIATE METHOD STATEMENT.

THIS DRAWING IS TO BE USED ONLY FOR THE PURPOSE OF ISSUE THAT IT WAS ISSUED FOR.

- NOTES:**
- ALL DIMENSIONS ARE IN METRES UNLESS OTHERWISE STATED.
  - THE INFORMATION ON THIS PLAN IS GIVEN WITHOUT OBLIGATION OR WARRANTY. NO LIABILITY OF ANY KIND WHATSOEVER IS ACCEPTED BY AECOM FOR ANY ERRORS OR OMISSIONS.
  - DRAWING IS BASED ON ORDNANCE SURVEY MAPPING AND TOPOGRAPHICAL SURVEY.
  - ITEMS IN GREY (APART FROM SOLID HATCHING) REPRESENT EXISTING INFRASTRUCTURE AND ARE TO REMAIN UNLESS STATED OTHERWISE.
  - PONDS INDICATED ON DRAWINGS ARE ALSO REFERRED TO AS MARSH AND WET GRASSLAND WITHIN LANDSCAPE DRAWINGS.
  - SEE LANDSCAPE DRAWINGS FOR THE NEW LANDSCAPE FEATURES AND EXISTING TREE RETENTION DETAILS.

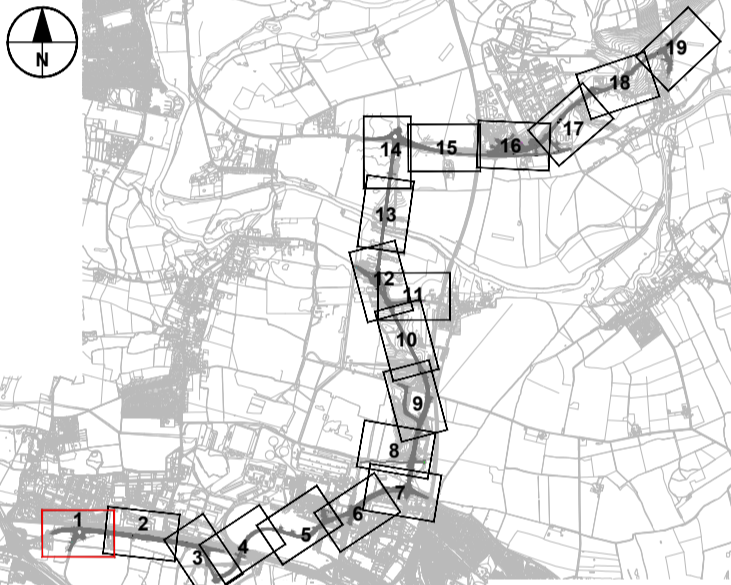
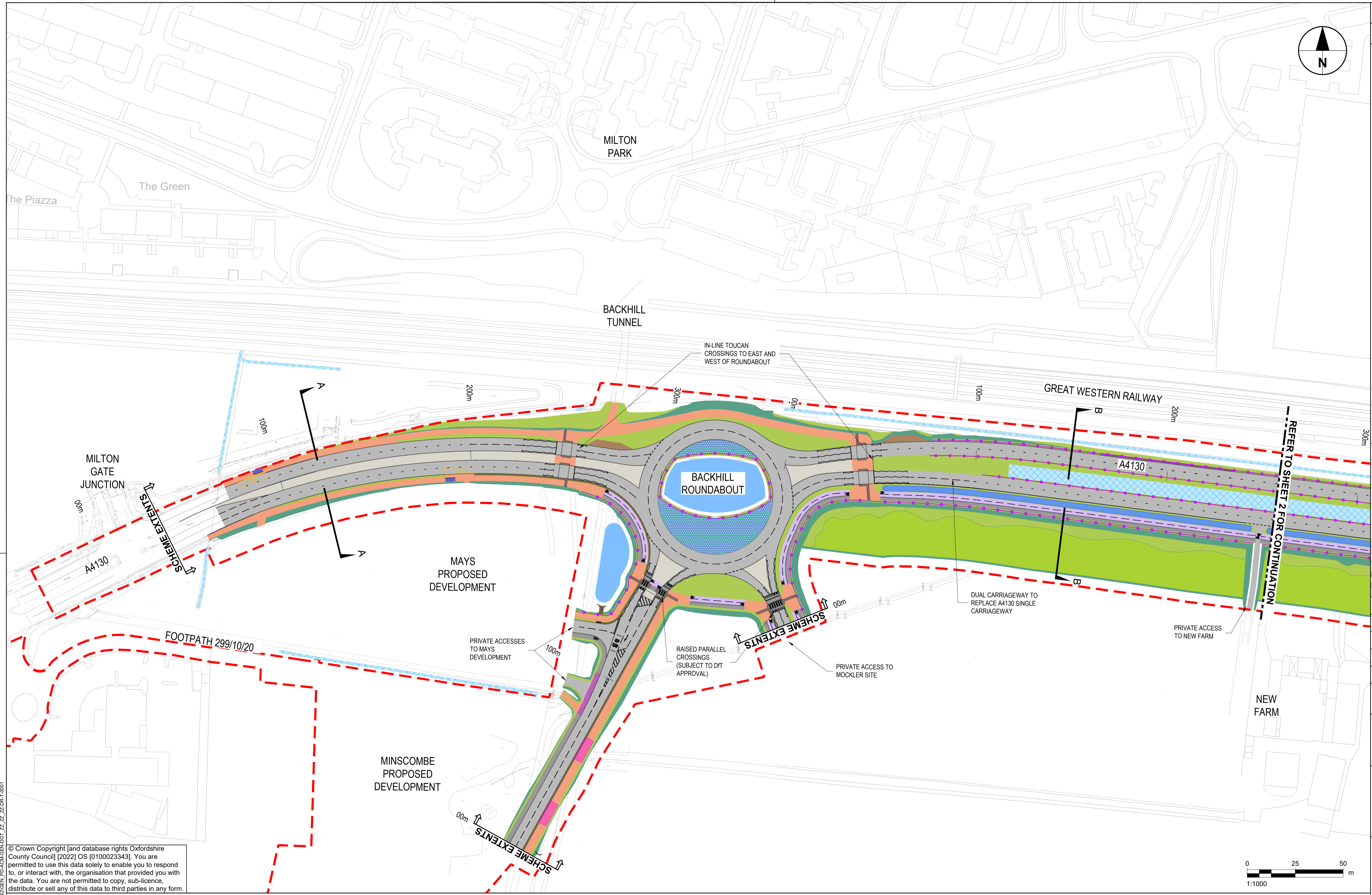
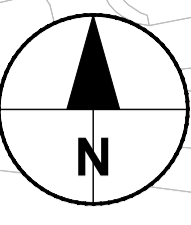

| Version          | By          | Date     | Suffix |
|------------------|-------------|----------|--------|
| FIRST VERSION    | AZ<br>KC    | 21/07/21 | P01    |
| SECOND VERSION   | AZ<br>AGB   | 09/09/21 | P02    |
| THIRD VERSION    | RBF<br>AA   | 13/06/22 | P03    |
| REVISION DETAILS | By<br>Check | Date     | Suffix |

Purpose of issue  
**SUITABLE FOR APPROVAL**

Client  
**OXFORDSHIRE COUNTY COUNCIL**

Project Title  
**DIDCOT GARDEN TOWN HOUSING INFRASTRUCTURE FUND (HIF 1)**

Drawing Title  
**A4130 WIDENING GENERAL ARRANGEMENT SHEET 1 OF 19**

|                                      |                   |  |                 |                  |
|--------------------------------------|-------------------|--|-----------------|------------------|
| Designed<br>AZ                       | Drawn<br>RBF      | Checked<br>AA  | Approved<br>AGB | Date<br>26/06/23 |
| Internal Project No.<br>60632497     | Suitability<br>S4 | Scale @ A1<br>1:1000   |                 |                  |
| Discipline<br>Town & Country Planner |                   | THIS DOCUMENT HAS BEEN PREPARED PURSUANT TO AND SUBJECT TO THE TERMS OF AECOM'S APPOINTMENT BY ITS CLIENT. AECOM ACCEPTS NO LIABILITY FOR ANY USE OF THIS DOCUMENT OTHER THAN BY ITS ORIGINAL CLIENT OR FOLLOWING AECOM'S EXPRESS AGREEMENT TO SUCH USE, AND ONLY FOR THE PURPOSES FOR WHICH IT WAS PREPARED AND PROVIDED. |                 |                  |

**AECOM**  
63-77 Victoria Street  
St Albans  
Herts  
AL1 3ER  
Tel: +44 (0) 172 7535 000  
www.aecom.com

**AECOM**  
AECOM Infrastructure & Environment UK Limited  
Registered in England Registered number: 880328  
Registered office: Midpoint, Alconon Link,  
Basingstoke, Hampshire RG21 7PP

| Work Package ID                 | Volume   | Type | Number | Rev |
|---------------------------------|----------|------|--------|-----|
| GEN_PD-ACM-GEN-DGT_ZZ_ZZ_ZZDR-T | -0001    |      |        | P04 |
| Originator                      | Location | Role |        |     |

© Crown Copyright [and database rights Oxfordshire County Council] [2022] OS [0100023343]. You are permitted to use this data solely to enable you to respond to, or interact with, the organisation that provided you with the data. You are not permitted to copy, sub-licence, distribute or sell any of this data to third parties in any form.

**KEY**

|   |                                  |
|---|----------------------------------|
| FOOTWAY                                 | POND                             |
| CYCLEWAY                                | GRASSED SURFACE WATER CHANNEL    |
| SHARED USE FOOTWAY                      | WATER BODY                       |
| CARRIAGEWAY                             | WETLAND AREA                     |
| OVERRUN AREA                            | SWALE / FILTER DRAIN             |
| GRASS VERGE / LANDSCAPED AREA           | PROPOSED DITCH                   |
| EMBANKMENT / LANDSCAPED AREA            | EXISTING DITCH                   |
| BUFFER STRIP                            | FLOOD ATTENUATION AREA           |
| CLEAR ZONE                              | VEHICLE CROSS OVER               |
| CUTTING                                 | HEADWALL                         |
| TRAFFIC ISLAND                          | WATERCOURSE                      |
| MAINTENANCE ACCESS / MAINTENANCE LAY-BY | NOISE BARRIER                    |
| ROAD MARKINGS                           | VEHICLE RESTRAINT SYSTEM BARRIER |
| REDLINE BOUNDARY                        | BRIDGE STRUCTURE                 |

Plot Date: 26 June 2022 15:27:17  
 File Name: C:\WORKING\ACM\GEN-DGT\_ZZ\_ZZ\_ZZDR-T\_ZZ\_ZZ\_ZZDR-T-0001